



## SSCN8050GS3

### NPN Switching Transistor

#### ➤ Features

VCB	VCE	VEB	IC
40V	25V	5V	1.5A

#### ➤ Description

The NPN Transistor is designed for use in linear and switching applications. The device is housed in the SOT89-3 package, which is designed for telephony and professional communication equipment.

#### ➤ Applications

- General purpose switching and amplification
- Telephony and professional communication equipment

#### ➤ Ordering Information

Device	Package	Shipping
SSCN8050GS3	SOT89-3L	3000/Reel

#### ➤ Pin configuration

Top view

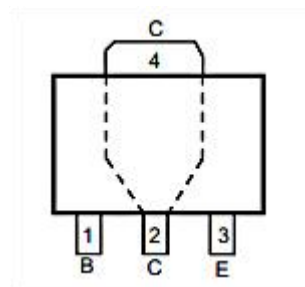

**SOT89-3L**

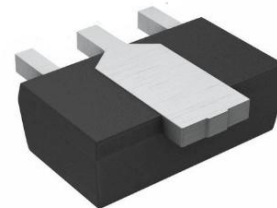

**Bottom view**

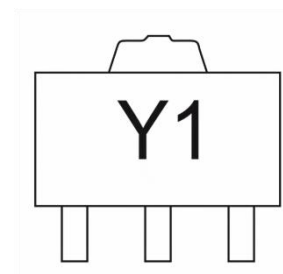

**Marking(Top View)**



➤ **Absolute Maximum Ratings**( $T_A = 25^\circ\text{C}$  unless otherwise noted)

Parameter	Symbol	Value	Unit
Collector-Base Voltage	$V_{CB0}$	40	V
Collector- Emitter Voltage	$V_{CEO}$	25	V
Emitter-Base Voltage	$V_{EBO}$	5	V
Collector Current-Continuous	$I_C$	1.5	A
Collector Power Dissipation	$P_C$	250	mW
Junction Temperature	$T_J$	-55 to 150	$^\circ\text{C}$
Storage Temperature	$T_{STG}$	-55 to 150	$^\circ\text{C}$

➤ **Electrical Characteristics** ( $T_A = 25^\circ\text{C}$  unless otherwise noted)

Parameter	Symbol	Test Conditions	Min.	Typ.	Max.	Unit
Collector-Base Breakdown Voltage	$BV_{CB0}$	$I_C = 100\mu\text{A}, I_E = 0$	40			V
Collector-emitter Breakdown Voltage	$BV_{CEO}$	$I_C = 0.1\text{mA}, I_B = 0$	25			V
Emitter -Base Breakdown Voltage	$BV_{EBO}$	$I_E = 100\mu\text{A}, I_C = 0$	5			V
Collector Cutoff Current	$I_{CBO}$	$V_{CB} = 40\text{V}, I_E = 0$			0.1	$\mu\text{A}$
Emitter Cutoff Current	$I_{CEO}$	$V_{CE} = 20\text{V}, I_E = 0$			0.1	$\mu\text{A}$
Emitter Cutoff Current	$I_{EBO}$	$V_{EB} = 5\text{V}, I_C = 0$			0.1	$\mu\text{A}$
DC Current Gain	$h_{FE1}$	$V_{CE} = 1\text{V}, I_C = 100\text{mA}$	85		400	
	$h_{FE2}$	$V_{CE} = 1\text{V}, I_C = 800\text{mA}$	40			
Collector-Emitter Saturation Voltage	$V_{CE(sat)}$	$I_C = 800\text{mA}, I_B = 80\text{mA}$			0.5	V
Base-Emitter Saturation Base-Emitter	$V_{BE(sat)}$	$I_C = 800\text{mA}, I_B = 80\text{mA}$			1.2	V
Base-Emitter Voltage	$V_{BE}$	$V_{CE} = 1\text{V}, I_C = 10\text{mA}$			1	V
Transition frequency	$f_T$	$V_{CE} = 10\text{V}, I_C = 50\text{mA}$ $f = 30\text{MHz}$	100			MHz
Collector output capacitance	$C_{ob}$	$V_{CB} = 10\text{V}, I_E = 0,$ $f = 1\text{MHz}$			15	pF



➤ **Typical Performance Characteristics ( $T_A = 25^\circ\text{C}$  unless otherwise noted)**

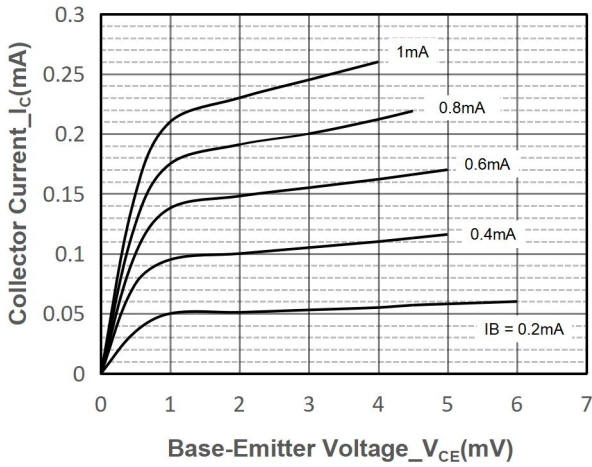

**Collector Current vs. Base-Emitter Voltage**

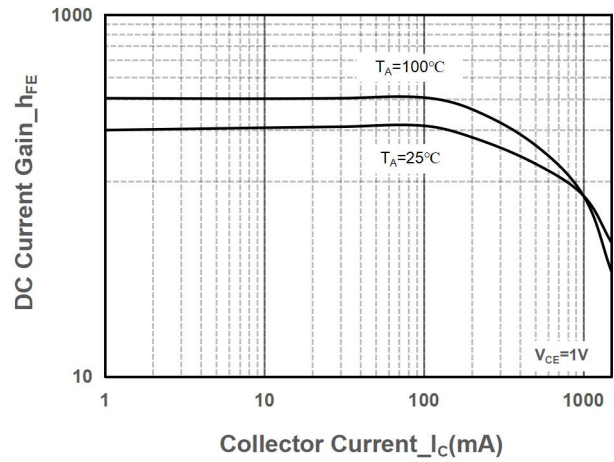

**DC Current Gain vs. Collector Current**

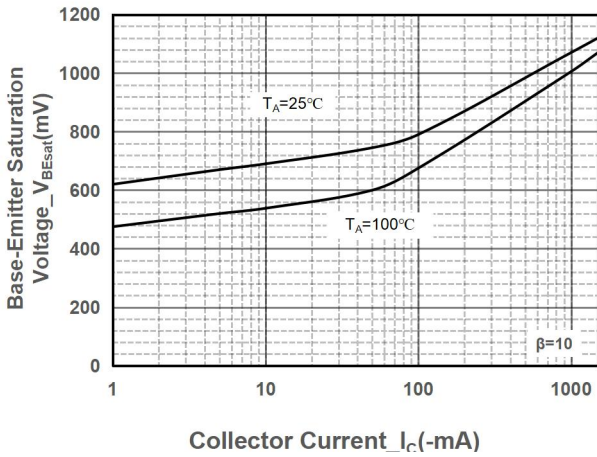

**$V_{BE(sat)}$  vs. Collector Current**

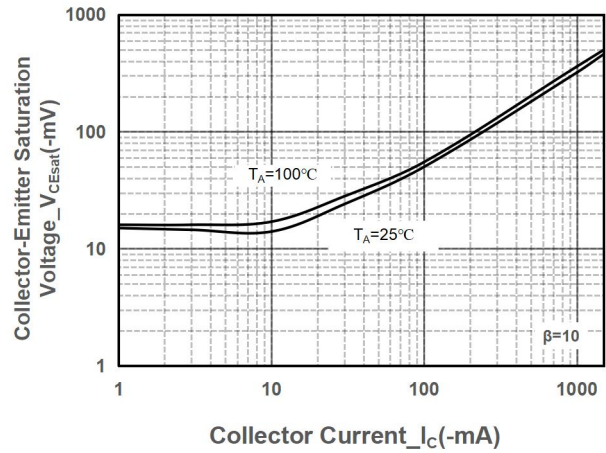

**$V_{CE(sat)}$  vs. Collector Current**

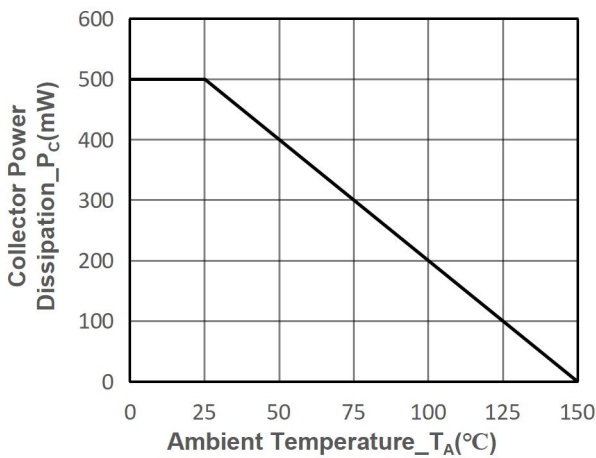

**Power derating vs. Ambient temperature**

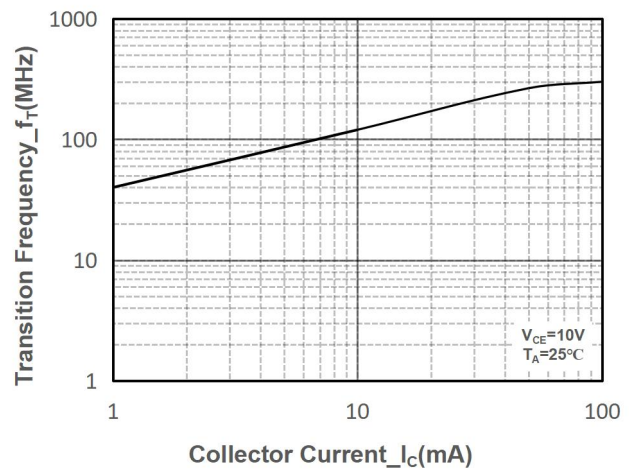

**Transition Frequency vs. Collector Current**

## ➤ Package Information

### SOT89-3L

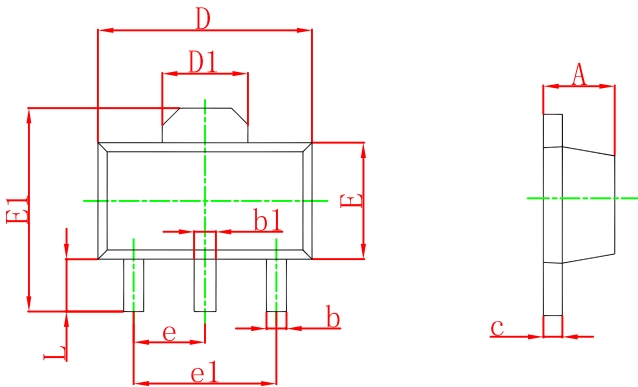

DIM	Millimeters		
	Min.	Typ.	Max.
A	1.400		1.600
b	0.320		0.520
b1	0.400		0.580
c	0.350		0.440
D	4.400		4.600
D1		1.550	
E	2.300		2.600
E1	3.940		4.250
e		1.500	
e1		3.000	
L	0.900		1.200

### Recommended Pad outline (Unit: mm)

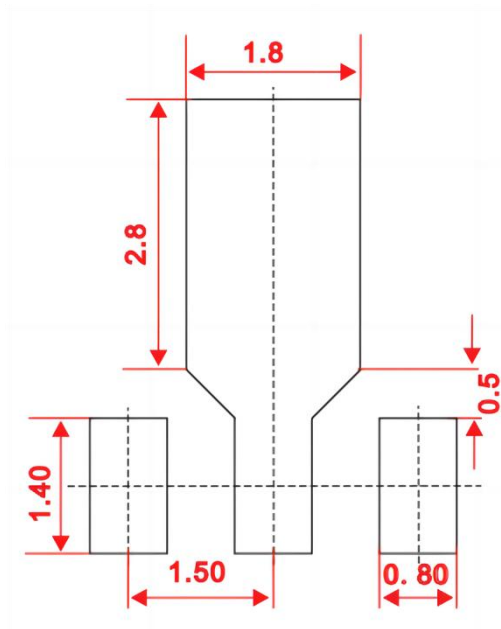



## DISCLAIMER

SSCSEMI RESERVES THE RIGHT TO MAKE CHANGES WITHOUT FURTHER NOTICE TO ANY PRODUCTS HEREIN TO IMPROVE RELIABILITY, FUNCTION OR DESIGN. SSCSEMI DOES NOT ASSUME ANY LIABILITY ARISING OUT OF THE APPLICATION OR USE OF ANY PRODUCT OR CIRCUIT DESCRIBED HEREIN; NEITHER DOES IT CONVEY ANY LICIENCE UNDER ITS PATENT RIGHTS, NOR THE RIGHTS OF OTHERS.

THE GRAPHS PROVIDED IN THIS DOCUMENT ARE STATISTICAL SUMMARIES BASED ON A LIMITED NUMBER OF SAMPLES AND ARE PROVIDED FOR INFORMATIONAL PURPOSE ONLY. THE PERFORMANCE CHARACTERISTICS LISTED IN THEM ARE NOT TESTED OR GUARANTEED. IN SOME GRAPHS, THE DATA PRESENTED MAY BE OUTSIDE THE SPECIFIED OPERATING RANGE (E.G. OUTSIDE SPECIFIED POWER SUPPLY RANGE) AND THEREFORE OUTSIDE THE WARRANTED RANGE.

OUR PRODUCT SPECIFICATIONS ARE ONLY VALID IF OBTAINED THROUGH THE COMPANY'S OFFICIAL WEBSITE, CRM SYSTEM, OR OUR SALES PERSONNEL CHANNELS. IF CHANGES OR SPECIAL VERSIONS ARE INVOLVED, THEY MUST BE STAMPED WITH A QUALITY SEAL AND MARKED WITH A SPECIAL VERSION NUMBER TO BE VALID.